

Section 6 Studios and operations



Section 6 - Studios and Operations

i. Location

The main station headquarters will be located at Westgate Business Park, Ballymount, Dublin 24.

ii. Building Description

The building is extant, and is in use by TV3. The radio facilities will be constructed within this building but will be self-contained. The building is of steel frame and concrete construction. Permitted uses are office, light industry and technology and is easily accessible for people with disabilities.

The studios at the Ballymount base will be appointed as follows:

- Studio 1 – main on-air use
- Studio 2 – programme production and on-air use
- News - news reading and news production
- Production – preparation and recording of commercials, jingles, programme elements etc.

In addition the racks room will house all programme interface equipment, transmission processing and linking equipment, outside source feeds, studio computer hardware, structured cabling patches and monitoring/measuring equipment.

In addition, a full studio will be located in Cork, with additional 'contribution' facilities in Galway, and in Limerick.

iii/iv Studio construction, plant and security

The studio-dividing walls will be constructed from solid 9" concrete blocks. This will also be extended to include the racks area help isolate studio borne noise from the main office. All the external block work will be plaster finished ready for a paint finish. Solid ash skirting, architrave and dado rail will be fitted into the sound lock and soft wood skirting and architrave fitted to the racks area.

Acoustic treatment, internal walls:

The internal walls will have 75mm stud fixed to them at 600mm c/c. The stud gap will be filled with 75mm Rockwool and capped with a layer of 3mm acoustic board pinned to the stud. A tight weave lightweight block will then be applied to the acoustic board to stop any loose fibres escaping.

Internal finish:

Hessian weave (Fire grade to BS476 Part-7 Class 1) will be applied to the walls. The studios will have a suspended ceiling installed using the traditional 600 x 600mm grid system. Stratos punched recessed tiles will be used to reduce noise reflections within the rooms and provide a pleasant cosmetic finish.

Windows between studios and view to main office:

The main window between studios will be constructed using four layers of 6.4mm whisper laminated glass. Each panel will be cushioned with acoustic gasket on either side. Each external pane will be angled to reduce internal sound reflections.

The other two windows will be constructed in the same method, but will have three layers of glass.

Construction of the acoustic doors:

Solid one-hour fire door with ash laminated finish set in a solid ash frame.

A double glazed viewing window with and bevelled ash trim;

A magnetic seal around the perimeter of the door with an anodised satin aluminium finish to match door furniture;

Door closure with adjustable pressure/ speed of closure;

An automatic 'rising threshold' door seal, mortised at the bottom of the doors which activates when a door is opened.

Internal quiet lobby finish:

The quiet lobby will be finished in the same décor as the main studio. The ceiling will be suspended with two category-2 light boxes fitted.

Lighting:

Lighting in the studios will be five 50w mains voltage chrome adjustable halogen lamps. These will be controlled on a chrome dimmer in each studio. The position of the lights will be fitted to suit studio furniture layout. There will also be a 20w emergency light fixed above the studio door along with a concealed test switch on the external studio wall.

The building will be feature electric storage type heating, and a ducted fresh air intake and exhaust air outtake system.

The studio rooms will be fitted with a separate air conditioning system, using acoustic ducting with adjustable dampers, fed from a remote central plenum. This design will feature acoustic isolation between rooms of 70dB(A) and system noise of -80dB(A). The studio air conditioning plant will be located above, but isolated from, the studio block.

Access to the studio complex will be protected by 'keyfob' type electronic access, which prevents unauthorised entry. The system also logs and identifies all entry and exit movements. The building also has 24 hour security on site.

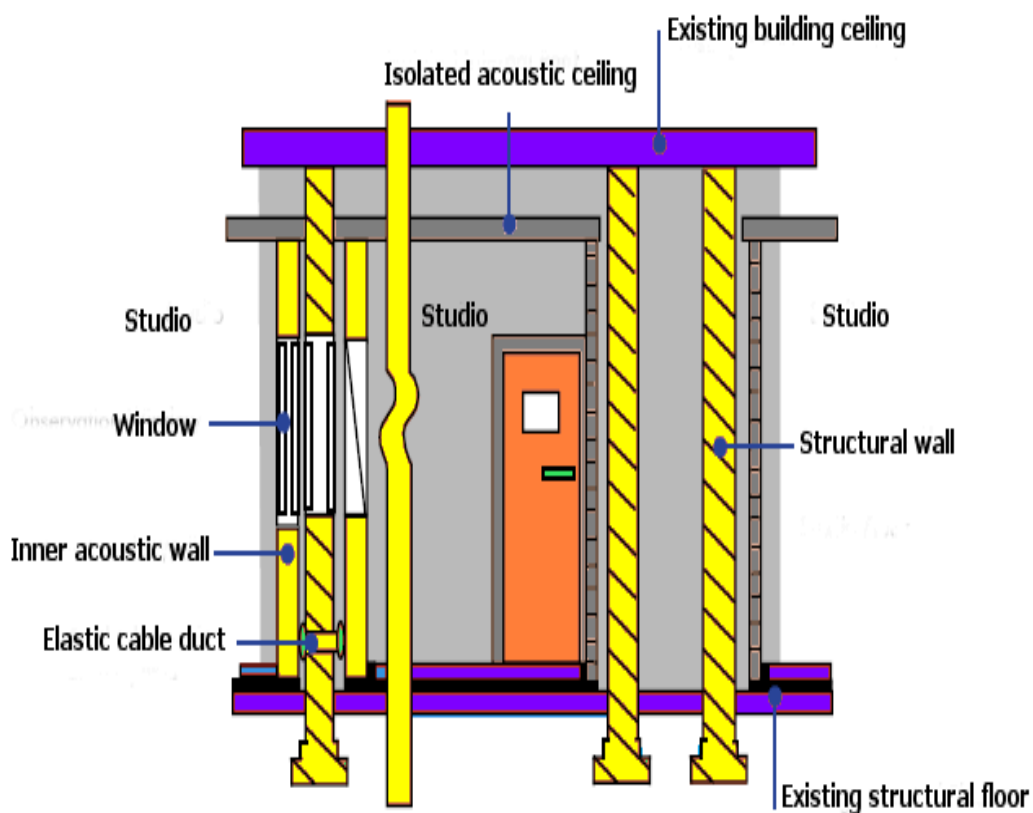

Design features of studio construction

The building is fitted with an auto-start generator and uninterruptible power supply with associated transfer panel. Mission critical equipment is also protected by Uninterruptible Power Supplies.

Throughout the studio complex, studio furniture is constructed of Ash with acoustic inlays. The layout has been designed with at least 900mm space surrounding the furniture to allow disabled persons' access, and the worktop heights are between 750 and 850mm as recommended for wheelchair users, in accordance with Part M of the NDA Guidelines.

In addition the toilet block has also been designed to accommodate disabled persons.

Access to the studio block is controlled by a secure door, with electronic 'keyfob' lock.

An additional fire exit is provided from the studio block, consisting of an acoustic door with internal release bars.

All studios and office areas comply with relevant building regulations particularly in regard to disabled persons' access.

See drawing on following page for studio floor plan.

Station Layout - Ballymount

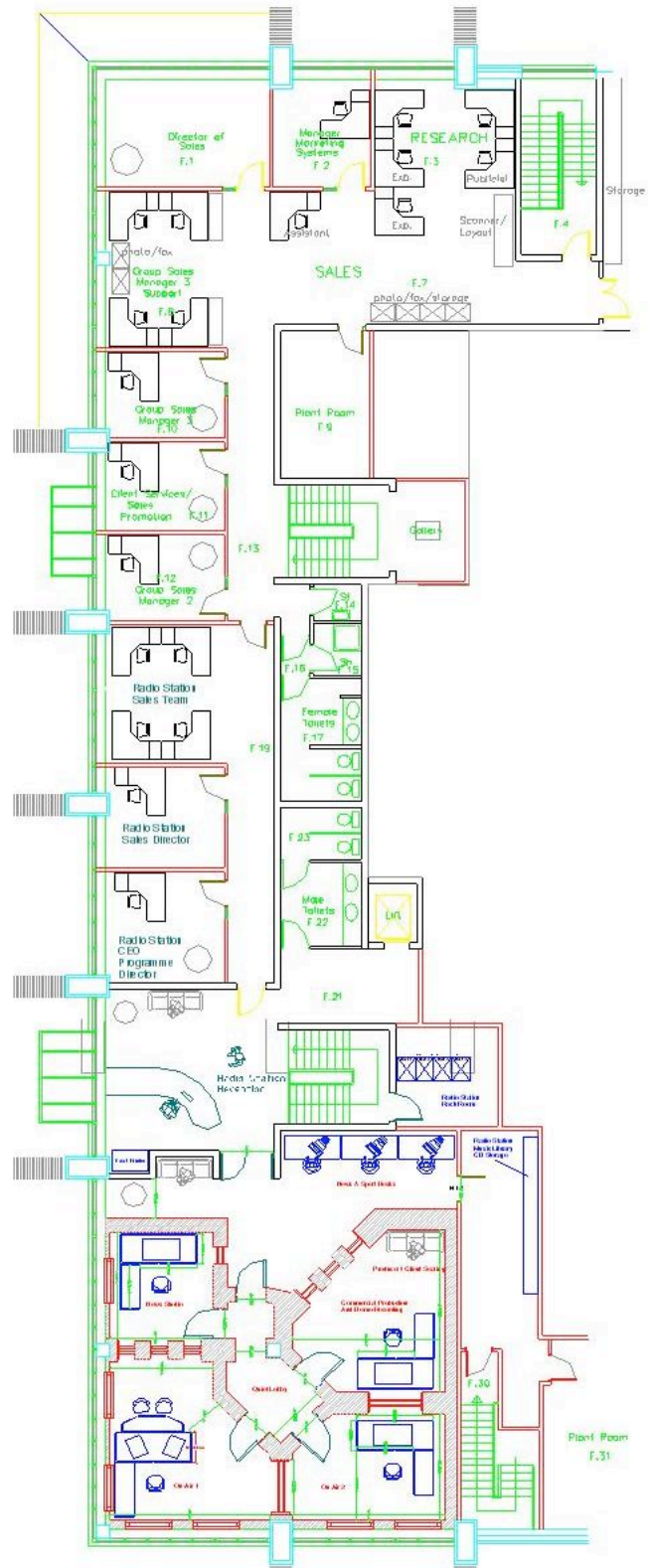

vi) Itemised lists of principal technical equipment.
DUBLIN STUDIO 1

1. Mixing desk, Klotz Digital Aeon-12	1	21784	21784
2. Furniture, custom acoustic	1	4900	4900
3. Presenter microphone, Shure SM-7B	1	579	579
4. Guest microphones, Shure SM-7B	2	579	1158
5. Headphones, Beyer DT100	3	145	435
6. CD Player, Denon DN-CD635	2	599	1198
7. Microphone stands and PC monitor arms	3	533	1599
8. Monitor speakers, with amplifiers	1	732	732
9. Digital Distribution amplifier	1	448	448
10. Monitor speaker brackets	1	250	250
11. Red lights and switcher	1	560	560
12. Installation sundries, hardware	1	3520	3520

Equipment Capital: €37,163.00

DUBLIN STUDIO 2

1. Mixing desk, Klotz Digital Aeon-12	1	21784	21784
2. Furniture, custom acoustic	1	4900	4900
3. Presenter microphone, Shure SM-7B	1	579	579
4. Guest microphones, Shure SM-7B	2	579	1158
5. Headphones, Beyer DT100	3	145	435
6. CD Player, Denon DN-CD635	2	599	1198
7. Microphone stands and PC monitor arms	3	533	1599
8. Monitor speakers, with amplifiers	1	732	732
9. Digital Distribution amplifier	1	448	448
10. Monitor speaker brackets	1	250	250
11. Red lights and switcher	1	560	560
12. Installation sundries, hardware	1	3520	3520

Equipment Capital: €37,163.00

CORK

1. Mixing desk, Klotz Digital Aeon-12	1	21784	21784
2. Furniture, custom acoustic	1	4900	4900
3. Presenter microphone, Shure SM-7B	1	579	579
4. Guest microphones, Shure SM-7B	2	579	1158
5. Headphones, Beyer DT100	3	145	435
6. CD Player, Denon DN-CD635	2	599	1198
7. Microphone stands and PC monitor arms	3	533	1599
8. Monitor speakers, with amplifiers	1	732	732
9. Digital Distribution amplifier	1	448	448
10. Monitor speaker brackets	1	250	250
11. Red lights and switcher	1	560	560
12. Installation sundries, hardware	1	3520	3520
13. IP codec (w/ISDN b/u)	1	8450	8450

Equipment Capital: €45,613.00

DUBLIN NEWS

1. Mixing desk, Klotz Digital Xenon-6	1	6800	6800
2. Microphones, Shure SM-7B	2	579	1158
3. Headphones, DT100	2	145	290
4. Telephone hybrid, D&R Hybrid-2	1	550	550
5. pair monitor speakers inc amplifiers	1	732	732
6. Digital Distribution amplifier	1	448	448
7. speaker mounting brackets	1	240	240
8. Installation sundries/hardware	1	2350	2350
9. Red lights and controller	1	560	560
10. Mic and PC monitor mountings	2	533	1066

Equipment Capital: €14,194.00

LIMERICK

1. Mixing desk, Klotz Digital Xenon-6	1	6800	6800
2. Microphones, Shure SM-7B	2	579	1158
3. Headphones, DT100	2	145	290
4. Telephone hybrid, D&R Hybrid-2	1	550	550
5. pair monitor speakers inc amplifiers	1	732	732
6. Digital Distribution amplifier	1	448	448
7. speaker mounting brackets	1	240	240
8. Installation sundries/hardware	1	2350	2350
9. Red lights and controller	1	560	560
10. Mic and PC monitor mountings	2	533	1066
11. IP Codec (w/ISDN b/u)	1	8450	8450

Equipment Capital: €22,644.00

GALWAY

1. Mixing desk, Klotz Digital Xenon-6	1	6800	6800
2. Microphones, Shure SM-7B	2	579	1158
3. Headphones, DT100	2	145	290
4. Telephone hybrid, D&R Hybrid-2	1	550	550
5. pair monitor speakers inc amplifiers	1	732	732
6. Digital Distribution amplifier	1	448	448
7. speaker mounting brackets	1	240	240
8. Installation sundries/hardware	1	2350	2350
9. Red lights and controller	1	560	560
10. Mic and PC monitor mountings	2	533	1066
11. IP codec (w/ISDN b/u)	1	8450	8450

Equipment Capital: €22,644,00

DUBLIN PRODUCTION

1. Mixing desk, Klotz Digital Aeon-8	1	16419	16419
2. Microphones, AKG C4500B	2	560	1120
3. Microphone processor	2	1719	3438
4. Headphones, Beyer DT100	2	145	290
5. CD Player, Denon DN-CD635	1	599	599
6. Microphone and PC monitor mountings	1	533	533
7. Monitor speakers, pr incl amplifiers	1	732	732
8. Digital Distribution Amplifier	1	448	448
9. Speaker mounting brackets	1	240	240
10. Installation sundries, hardware	1	3200	3200
11. Red lights and switcher	1	560	560

Equipment Capital: €27,579.00

ENGINEERING

1. Distribution amplifiers	4	349	1396
2. Microwave transmitter - dual redundant system	1	18650	18650
3. Microwave dish incl. cable/connectors etc	2	1250	2500
4. Equipment racks	4	600	2400
5. ISDN codec	2	4750	9500
6. Studio telephone system (studios 1 and 2)	2	4650	9300
7. Krone field	1	1250	1250
8. Audio processor, Optimod-FM 8500	1	16450	16450
9. Backup audio processor, Optimod-FM 2300	1	5115	5115
10. Synchronised master clock system (4 studios)	1	5750	5750
11. Receivers, Sony STS-E700	2	240	480
12. Transmission router and talkback master	1	3550	3550
13. PC-based logger	1	5800	5800
14. INN/AdSat receive equipment	1	6250	6250
15. Talkback stations	4	595	2380
16. Digital/Analogue converters	4	523	2092
17. Tieline Codec (for OBs, remotes etc)	1	4367	4367
18. Tieline portable codec	1	5984	5984
19. Portable hard disk recorders for reporters	2	651	1302
20. Hand-held reporter's mics	2	168	336
21. Background speaker system incl. amp/8 speakers	1	2150	2150
22. Headsets for sports reporters and news workstations	4	240	960

ENGINEERING (cont)

23. News workstations	4	2590	10360
24. Telephone hybrids for news workstations	4	463	1852
25. Web streaming PC w/processor and codec	1	3100	3100
26. PC for studio internet/text messaging etc	3	1100	3300
27. IP codecs (connx.To remote studios)	3	8450	25350
28. Music and commercial playout system RCS	1	66500	66500

Equipment Capital: €218,424.00

I.T.

1. Building IT network hardware incl. outlets, switched hub, patch panels etc in all locations	1	12550	12550
--	---	-------	-------

Equipment Capital: €12,550.00

TOTALS

Equipment Capital:	€437,974.00
Installation:	€68,400.00
Studios Grand Total:	€506,374.00

vii) Building refurbishment, studio construction, office fixtures, fittings and IT

STUDIO, OFFICE & I.T.

	€'000
Studio Construction	240
Office Fixtures & Fittings	
Office complex telephone system/phonebox	40
Office Furniture	20
Studio furnishings	60
Computers & Office Equipment	
Photocopiers, printers, faxes, TV's & projectors	80
Office computers	100
Server & communications hardware	100
Total	640

viii) Existing building

Although the building is extant, the radio station will be a new build